

Ensure that all tools required are present as they are required for a successful assembly and installation of the patio door.



For Additional details regarding patio door installation or other details, go to Dashwood Windows and Doors website at www.dashwood.com or use the 2D barcode to the left. It will take you directly to the installation instructions on the website.

STEP 1: Prepare Opening:

Is the opening the correct size for the patio door unit? Check it against the patio frame size now, before installation. The opening should be frame height plus 1/2" to 1", and frame width plus 1/2" to 1".



STEP 2: Sill Preparation

For all types of installation, be sure to seal the flashing to the exterior building wrap. The sill must be installed level and uniformly supported from end to end, and front to back. Use a level and solid shim(s) to compensate for unevenness in the opening.

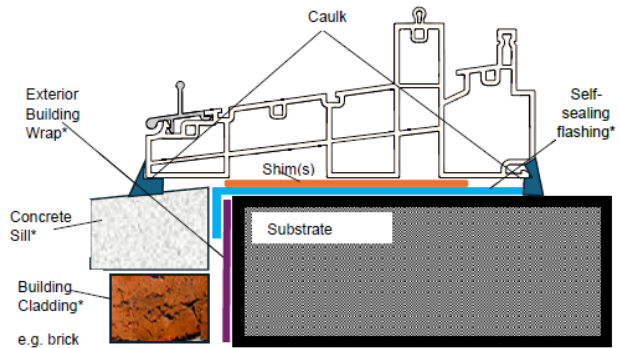

STEP 3a: Sill Pan Installation:

Place the right and left sill pan ends onto the caulk beads and tightly against the side of the opening. Then, liberally coat the overlapped areas and the recessed areas of the pieces with PVC cement. Place center section(s) in position and hold pieces together long enough to ensure a good bond.



For added protection, spread a bead of caulk along the glue joints and to prevent air infiltration, run a bead of caulk along the lower interior edge of the sill pan. Additional caulking could affect the performance of the sill pan.



STEP 3b: Installing Without a Sill Pan:

Lay the patio door unit on edge or face so that the bottom surface of the sill can be caulked. Place very large beads of caulk across the full width of the sill. Additionally, place beads of caulk along the junction of the sill and the jamb and on the bottom surface of the jambs and brickmould.

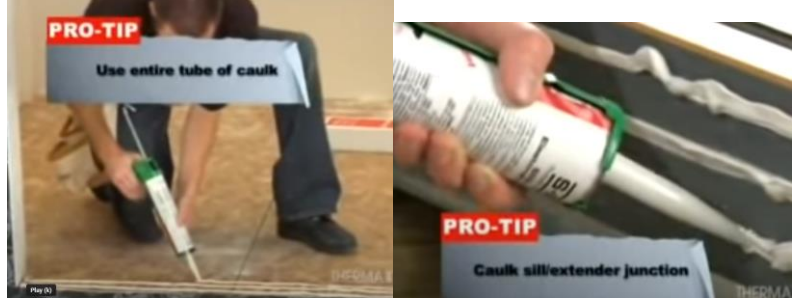

STEP 3c: Installing Blue Skin

Place very large beads of caulk across the full width of the sill.

The blueskin membrane effectively seals and shields structures against ice and water, as well as moisture damage.

Be sure to seal the flashing to the exterior building wrap.



STEP 4: Place Unit into Opening:

It is recommended that a pair of fasteners are installed at each location for the header and jambs; one in the inner track, and the other in the outer track.

Set shims behind the frame installation holes. Use a level and measure frame to ensure it is plumb, square and level.

Adjust the shims as necessary and securely fasten all screws.

